

# HANDBOOK FOR VISITORS

## EBA OFFICES PARIS

**eba** | European  
Banking  
Authority



## Location of the EBA offices

### EUROPEAN BANKING AUTHORITY

Floor 27, Tour Europlaza  
20, Avenue André-Prothin  
92400 Courbevoie



+33 1 86 52 70 00



info@eba.europa.eu



Exact coordinates to the building main entrance:

48.891863, 2.244724

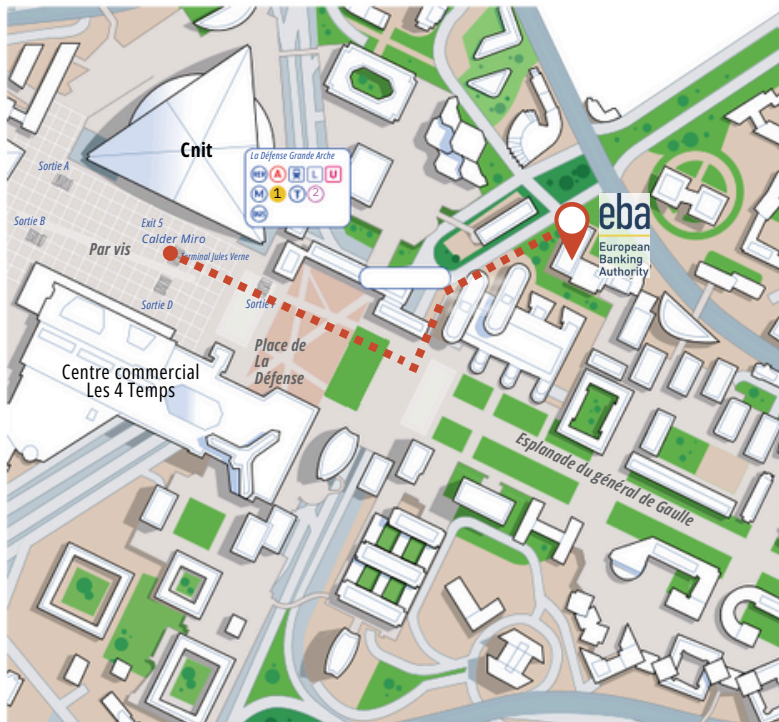



# Sustainability at the EBA

As an **EMAS** registered Agency, the EBA is committed improving its environmental performance and reducing its carbon footprint.

## HOW CAN YOU CONTRIBUTE TO A GREENER EBA?



Choose sustainable means of transport: travel by train instead of flying, select direct and low emission connections, use public transport.



Stay in **green-certified** or eco-labelled accommodation close to the meeting venue.



Choose vegetarian or vegan catering options.



Reduce the printing of documents by consulting and sharing them digitally.



Compensate the carbon footprint from your travel with transport companies or dedicated offsetting schemes.

You can find more information on the EBA's engagement to become a greener agency on our [website](#).

Thank you for your contribution.

*Together we can make a difference.*



**EMAS**

VERIFIED  
ENVIRONMENTAL  
MANAGEMENT  
FR-000098



# Travelling to the EBA

The EBA office is a 5-minute walk from the La Défense transport hub, which is easily accessible through various transports.

## PUBLIC TRANSPORT STATIONS

Metro



RER



Tramway



Transilien



La Défense Grande Arche

Exit 5: Calder – Miró

Metro Line 1, RER A, Tramway 2 and Transilien U and L all stop at La Défense Grande Arche.

For more travel information, visit Régie Autonome des Transports Parisiens (public transport operator based in Paris) at [ratp.fr](http://ratp.fr) and [transilien.fr](http://transilien.fr)

## Connections to airports and train stations

### Airports

From Paris Charles de Gaulle Airport

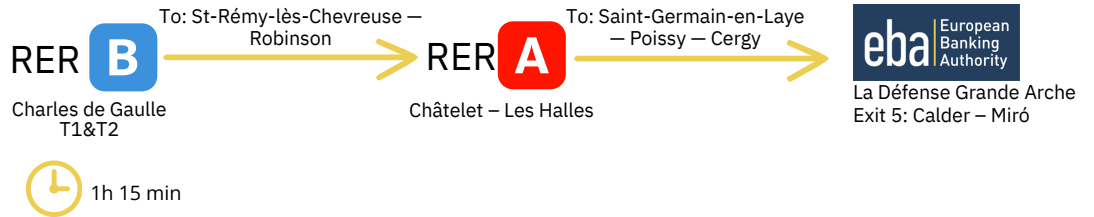

From Paris Orly Airport

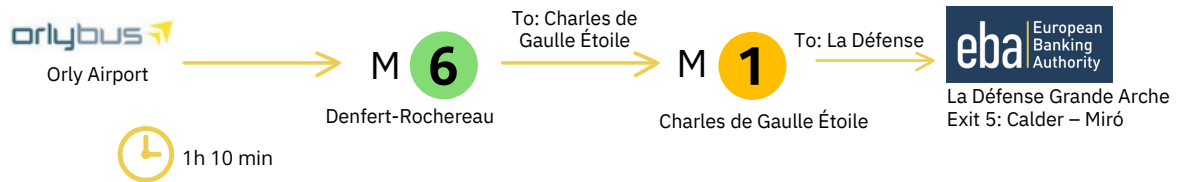
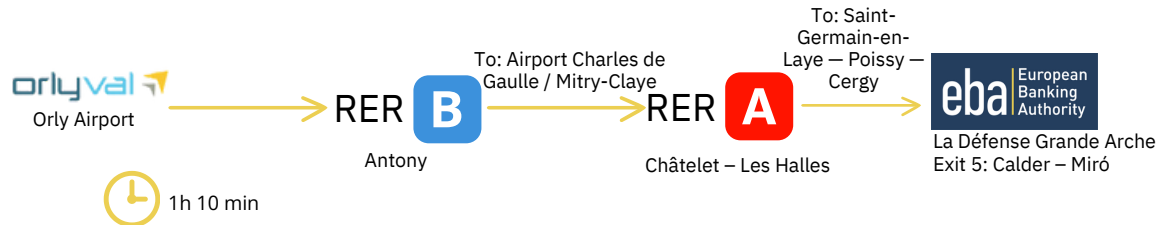



## Trains

From Gare du Nord Train Station

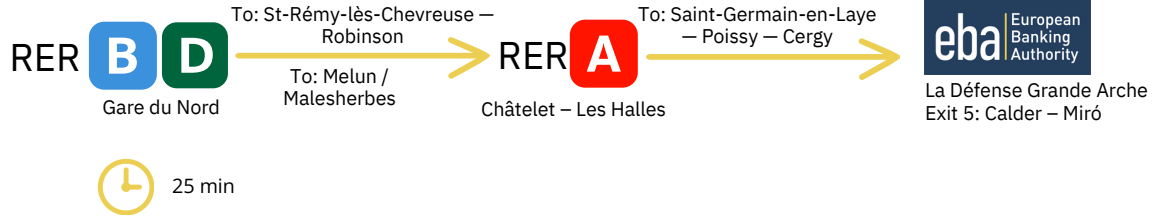

From Gare de l'Est train station

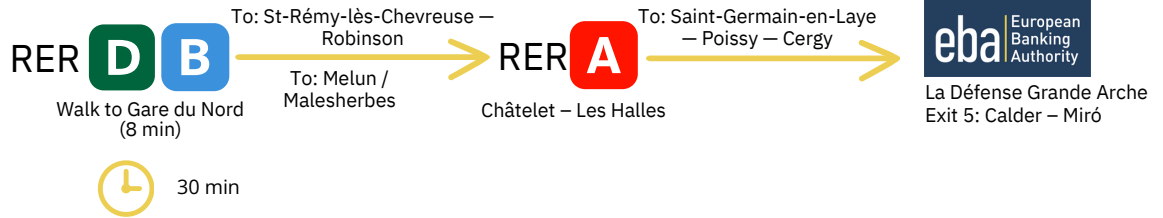

Useful links: [parisaeroport.fr](http://parisaeroport.fr) & [ratp.fr](http://ratp.fr)

## Parking at Europlaza and La Défense

The EBA has limited car parking spaces reserved for visitors and we recommend you contact the EBA reception before your visit, if you wish to reserve one.



+33 1 86 52 70 00



eba-officemanagement@eba.europa.eu

There are several car parks in the close proximity of the EBA offices at Europlaza. To see their location and indicative pricing, visit <https://fr.parkindigo.com/> or <http://www.parkingsparisladefense.fr/fr>



## When arriving at Europlaza

---

Upon your arrival, the Europlaza reception team will welcome you on the ground floor. Please inform them that you are visiting the EBA and proceed directly to the EBA reception desk on the 27th floor.

You will be shown the way to the group lifts to floor 27 and the receptionist will open the turnstile door for you.

A valid identity document (passport or ID card with a picture) is required for registration purposes.

If you received a QR code in your invitation, please scan it on our visitor's management tool at the EBA's reception to confirm your arrival.



Opening hours:

Europlaza Tower  
Mondays to Fridays  
8:00 – 19:00

EBA Reception  
Mondays to Fridays  
8:00 – 18:30



## Meeting rooms

The EBA has six meeting rooms for external participants, which are located on floor 27 of Europlaza.

The reception staff will inform you in which meeting room your meeting takes place. The meeting rooms are accessible and beverages available at the breakout areas 30 minutes ahead of the scheduled start of the meeting.

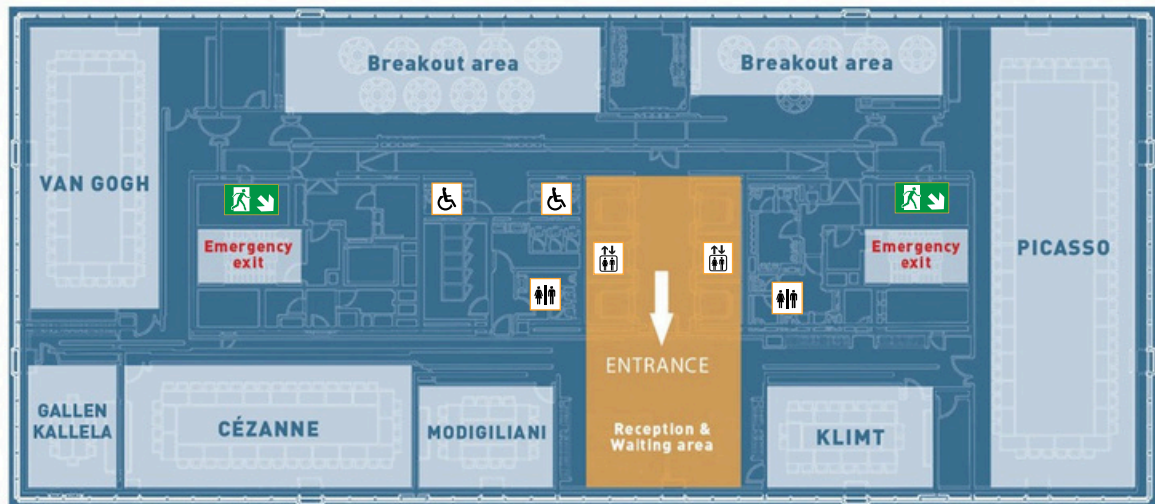

## Safety and security

### In case of an emergency on your floor:



You will hear a very loud alarm.



You *have* to leave the building immediately, using the stairs

Persons with reduced mobility will be directed to the safe havens for evacuation by the fire brigade.



On the ground floor, please exit the building from the emergency exit doors on sides of the building and *not* the revolving doors.



Once outside, go to the assembly point which is on the left side in front of the Europlaza Tower.



### First aid

If you or somebody else require assistance please contact the EBA Reception. Several staff members are trained in first aid and will be able to assist.

First aid kits are available in the main breakout area and an automated defibrillator is opposite the EBA reception.



Smoking and vaping is *not* allowed at the EBA premises and inside the Europlaza Tower. Please use the designated smoking areas outside the building.



For more information, please consult the emergency brochure enclosed to your meeting invitation email.



## Hotels

Listed below are some of the hotels within walking distance (10-15 minutes) from the EBA premises.

HOTEL PULLMAN PARIS LA DÉFENSE \*\*\*\*\*

11, Avenue De L'Arche, La Défense 6, 92400 Courbevoie  
+33 1 47 17 50 00

MELIA PARIS LA DÉFENSE \*\*\*\*

3 Boulevard de Neuilly, 92081 Courbevoie  
+33 1 75 57 99 00

NOVOTEL PARIS LA DÉFENSE \*\*\*\*

2 Boulevard De Neuilly, 92081 Courbevoie  
+33 1 41 45 23 23

HÔTEL MGALLERY NEST PARIS LA DÉFENSE \*\*\*\*\*

33 voie des Sculpteurs, 92800 Puteaux  
+33 1 47 76 44 43

HOTEL COURSEINE \*\*\*\*

18 Avenue Marceau, 92400 Courbevoie, France  
+33 1 43 33 57 04

RENAISSANCE PARIS LA DEFENSE HOTEL \*\*\*\*

60 cours Valmy, Paris La Défense 92918 France  
+33 1 41 97 50 50



CitizenM PARIS LA DÉFENSE \*\*\*\*

194 Jardin de l'Arche, 92000 Nanterre, France

+33 1 86 65 59 60

IBIS STYLES PARIS LA DÉFENSE COURBEVOIE \*\*\*

99 Rue Du Capitaine Guynemer, 92400 Courbevoie

+33 1 47 89 25 25



## Restaurants

---

### LE MOND

1 Place des Corolles, 92400 Courbevoie  
+33 1 47 75 97 11

### ECLIPSE

86 Espl. du Général de Gaulle, 92400 Courbevoie  
+33 1 40 89 21 56

### LE TOURNESOL

65 B avenue Gambetta, 92400 Courbevoie  
+33 1 47 89 07 40

### LE MIROIR

2 Espl. du Général de Gaulle, 92400 Courbevoie  
(Hotel Meliá Paris La Défense, 1st floor)  
+33 1 75 57 99 00

### QUINTE & SENS

11, avenue de l'Arche, 92081 La Défense  
Hôtel Pullman Paris La Défense  
+33 1 47 17 59 99

### LA BRASSERIE RESTAURANT & BAR

60 Cours Valmy, 92800 Puteaux (Hôtel Renaissance)  
+33 1 41 97 50 11

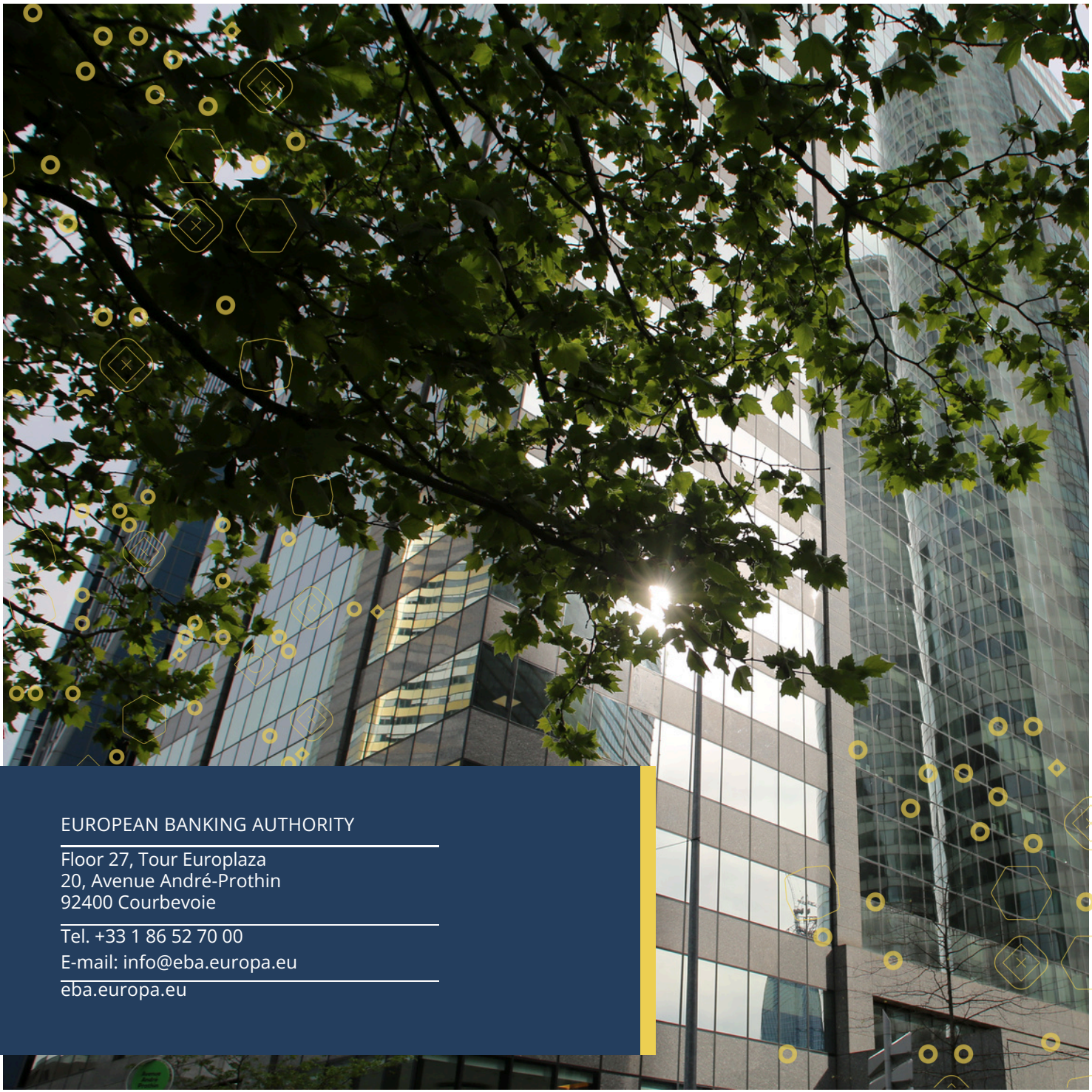

EUROPEAN BANKING AUTHORITY

---

Floor 27, Tour Europlaza  
20, Avenue André-Prothin  
92400 Courbevoie

---

Tel. +33 1 86 52 70 00

---

E-mail: [info@eba.europa.eu](mailto:info@eba.europa.eu)

---

[eba.europa.eu](http://eba.europa.eu)